



INSTALLATION GUIDES



WATERTIGHT SYSTEMS | BACKER BOARD | WATERPROOF MEMBRANE
PRE-SLOPED SHOWER PAN | DECOUPLING MAT | WATERPROOF BACKER BOARD

MiTek[®]

1-833-909-0839
TRITONWATERTIGHT.com

WATERTIGHT SYSTEMS OVERVIEW	3
BACKER BOARD	4
WATERPROOF MEMBRANE	5
PRE-SLOPED SHOWER PAN	6
DECOUPLING MAT	7
WATERPROOF BACKER BOARD	8



WATERTIGHT SYSTEMS



WATERPROOF MEMBRANE

- Provides a consistent layer of protection
- Vapor Barrier & Waterproof Membrane
- Free of VOC's and harsh chemicals

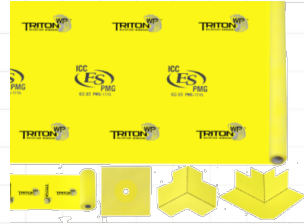

BACKER BOARD

- 15 lbs lighter per 1/2" sheet versus leading cement backers
- Free of Crystalline Silica, VOC's and harsh chemicals
- Easy to score and snap



WATERPROOF BACKER BOARD

- Factory applied waterproof and vapor barrier membrane
- Ultra-lightweight for streamlined install
- Easy to score and snap, fasten and install



PRE SLOPED PANS

- Save days on installation
- Factory Made 2% slope
- FHA drain compatible

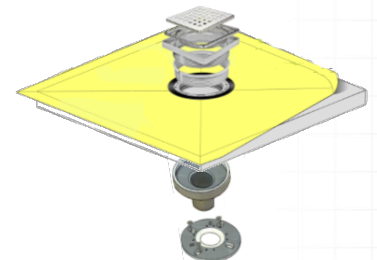

DECOUPLING MAT

- Light weight waterproof tile underlayment
- Prevents mold growth and grout discoloration
- Mortar lock mesh system for one pass mortar application

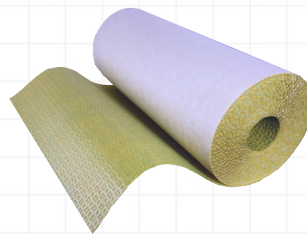

MiTek®

1-833-909-0839
TRITONWATERTIGHT.com

©2020 MiTek Industries, Inc. All Rights Reserved. #2593-1/2020

BK INSTALLATION GUIDE

1/4" FOR FLOORS AND 1/2" FOR WALLS



FLOOR INSTALLATION

F1 ENSURE SUBFLOOR IS STRUCTURALLY SOUND

- Replace any loose, warped, uneven or damaged sections
- Ensure subfloor is clean and flat
- Floor must be engineered not to exceed the L/360 deflection criteria or L/720 for natural stone
- Floor should comply with local building code and ANSI A108.11
- Use minimum 5/8" exterior grade plywood or minimum class 1 exposure 23/32 OSB with joist spacing not to exceed 24" o.c.

F2 DETERMINE LAYOUT

- Do not align backer with subfloor joints
- Do not allow 4 corners of backer board to meet
- Maintain 1/8" gap between all backer boards and a 1/4" gap between walls, cabinet base, tub, and shower pan.
- Cut backer to size and make necessary cutouts

F3 ATTACH BACKER TO SUBFLOOR

- Apply supporting bed of mortar that meets or exceeds ANSI A108.1 to subfloor using a 1/4" square notch trowel
- Embed backer into wet mortar
- Fasten backer with proper nails or screws every 8" in the field keeping 3/8" from the edge and 2" from the backer corners
- Set fasteners flush with backer
- A Minimum of 54 fasteners are required per backer sheet

F4 TAPE JOINTS PRIOR TO TILING

- Clean seams with damp sponge
- Fill joints with mortar
- Embed 2" wide high strength alkali resistant glass fiber tape into the mortar

WALL INSTALLATION

W1 ENSURE FRAMING IS STRUCTURALLY SOUND AND PROPERLY ALIGNED.

- Must Comply with ANSI A108.11 and local building code
- Use minimum 2"x4" wood studs or 20 gauge metal studs at maximum 16" o.c.

W2 DETERMINE LAYOUT

- Backer edges parallel to framing must be structurally supported
- Cut backer to size, make needed cutouts and holes
- Allow 1/8" gap between backer and 1/4" gap between floor, tub or shower pan. (to be caulked accordingly)

W3 ATTACH BACKER TO FRAMING MEMBERS

- Use proper nails or screws at maximum 8" o.c.
- Keep fasteners 3/8" from backer edges and 2" from backer corners
- Set fasteners flush with backer
- Approximately 25-30 fasteners are required per backer sheet

W4 TAPE JOINTS PRIOR TO TILING

- Clean seams with damp sponge
- Skim coat joints with same mortar planned to be used to set tile
- Embed 2" wide high strength alkali resistant fiberglass tape into the mortar
- Triton WP™ Tape can also be used over seams.

PROPER FASTENERS: CORROSION RESISTANT

Roofing Nails or Cement Backer Screws
Min. 1 1/4" for Floors and Interior Walls.
Min. 1 3/4" for Exterior Walls

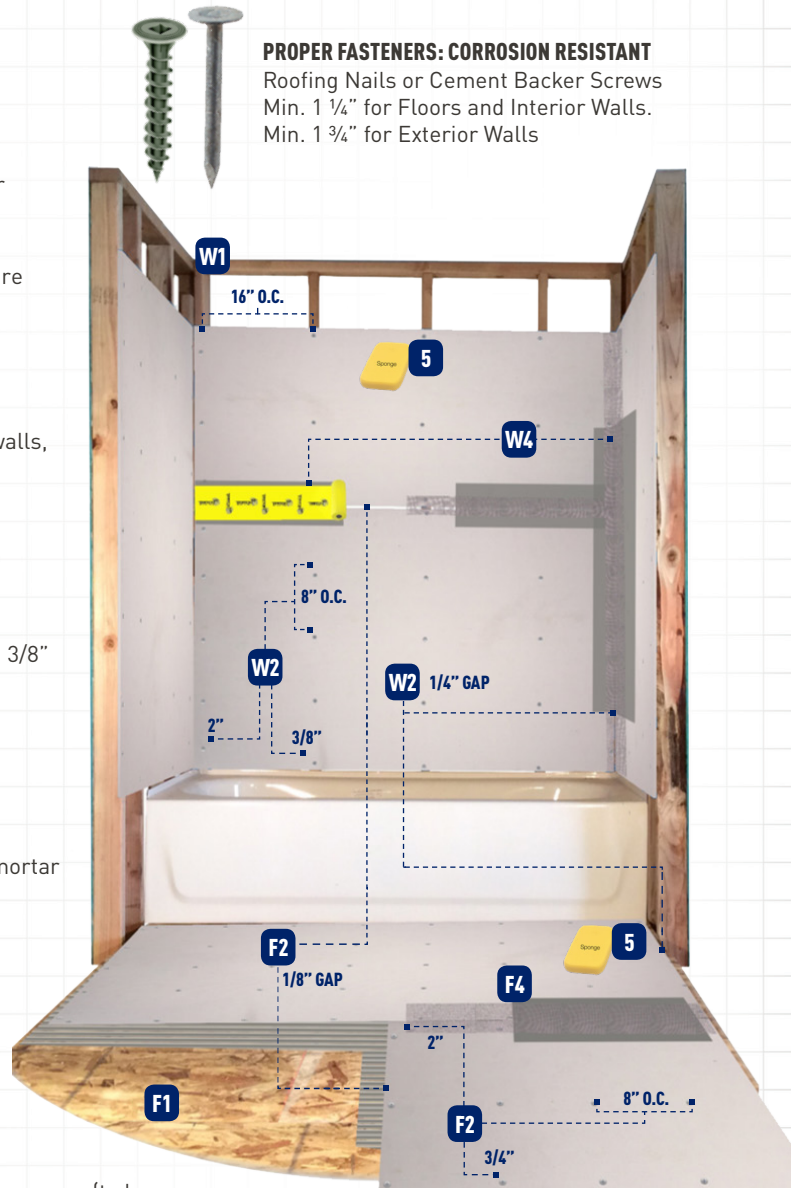

5 TO FINISH BK™ WITH WALL OR FLOOR TILE :

- Refer to mortar and tile manufacturers' application guidelines
- Wipe the surface of the backer with a DAMP SPONGE just prior to applying mortar to clean as well as dampen the backer.
- Minimum mortar requirement must meet or exceed ANSI A118.4

CUT TRITON BK™ WITH A UTILITY
KNIFE SCORE AND SNAP AWAY



MiTek®

1-833-909-0839
TRITONWATERTIGHT.com

©2020 MiTek Industries, Inc. All Rights Reserved. #2593-BK

WATERPROOF MEMBRANE



1
The substrate must be clean, even, and load bearing. Use a damp sponge to clean substrate.



2
Drywall substrates need a coat of primer.



3
Mark wall with WP™ Membrane perimeter lines



4
Precut WP™ Membrane to size including hole cuts for plumbing

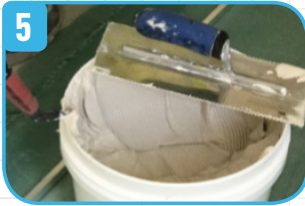

5
Use recommended mortar for substrate with maximum water per mortar manufacturers instructions



7a
Align WP™ Membrane and embed into mortar.

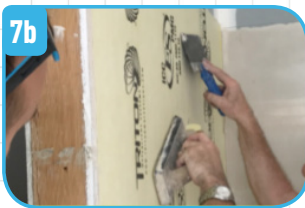

7b
Use float & broad knife working center outward to remove any air pockets and ensure good contact

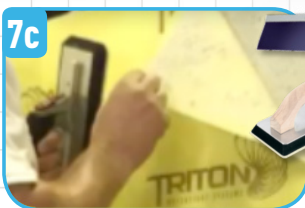

7c
Periodically check for 100% coverage



6
Skim coat wall where first WP™ sheet will go, then use 1/8" square notch (3mm) trowel to apply mortar bed

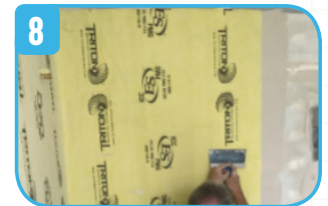

8
Repeat steps 6-7 for each remaining WP™ sheet ensuring any seams have a minimum 2" overlap (50mm)



9
Use same trowel / mortar method to apply preformed collars at any plumbing exposures

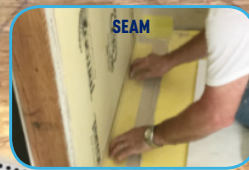

SEAM



INSIDE



OUTSIDE



CORNERS CAN GO ON TOP OR UNDERNEATH

11
Apply WP™ Tape at membrane seams where 2" (50mm) overlap was not achieved. Use preformed WP™ corners at all inside and outside corner locations. Collars, corners, and seam tape can be applied underneath or on top of WP™ sheets.



10
Niches and Bench Seats should also be covered with WP™ and treated with preformed corners.

PS INSTALLATION GUIDE

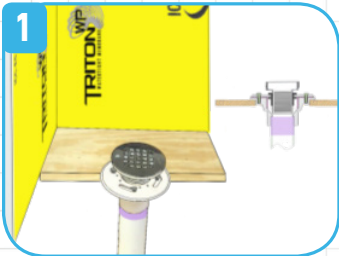

Plumber or approved trade should install FHA shower drain level and flush with subfloor.

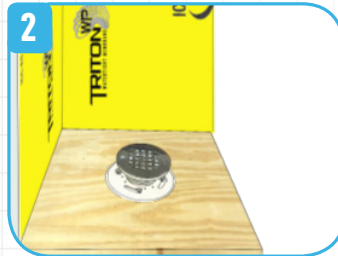

Installation of Triton PS™ can begin following proper installation of FHA shower drain.

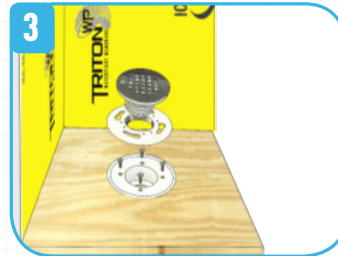

Remove 4 drain base bolts, locking collar and adjustable drain barrel.

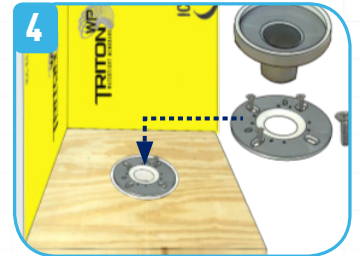

Apply a bead of silicone on the drain base. Then use flat head screws to attach FHA adapter ring (provided with PS™ Pan).

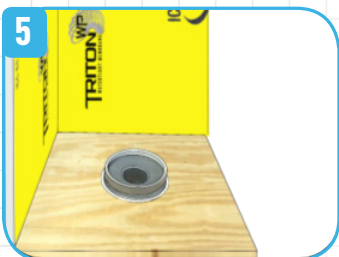

Notice snug fit of pan adapter and adapter ring due to adapter ring gasket.



Dry fit pan to ensure good fit. **Leave pan adapter** attached to back of pan - see step 8.

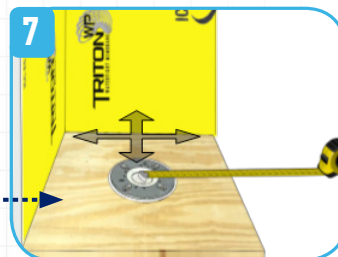

To cut PS™ measure from drain center to each edge and cut with utility knife or circular saw.

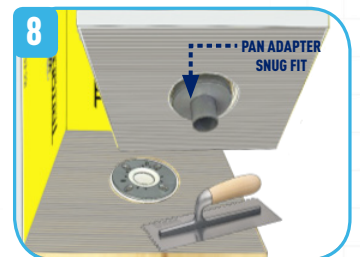

Using **1/4" square notch trowel**, apply approved mortar to subfloor and back of PS™ pan.



Fit PS™ Pan into fresh mortar and apply pressure to ensure Pan is well embedded.

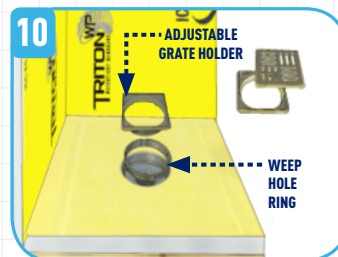

Rotate weep hole ring in flush with pan. Grate holder is height adjustable to tile thickness.

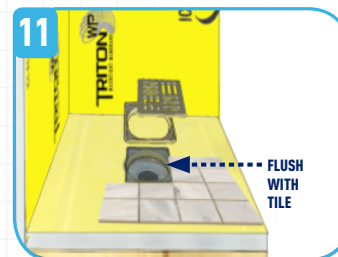

Use a bead of clear silicone along the top edge of adjustable grate holder prior to fitting grate tray.

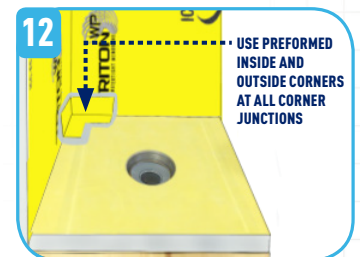

Ensure that all seams have a min. 2" overlap of WP™ fabric or seam tape adhered with mortar.



DCI INSTALLATION GUIDE

OVER WOOD OR CONCRETE SUBFLOOR



1 Ensure subfloor is flat. When applying over wood, ensure plywood or OSB is fastened correctly and meets deflection criteria for intended tile. Exterior applications may require proper sloping.



2 Remove any loose impediment from the subfloor (i.e.: Drywall debris, Paint, etc.) Sweep subfloor clean.



3 Wipe down subfloor with a damp sponge. This will ensure good adhesion by removing dust, while dampening subfloor to help avoid moisture loss in mortar. Some subfloors may need to be primed to achieve a good bond.



4 **IMPORTANT** to ensure a **Perimeter Movement Joint**, keep a 1/4" (6mm) space between walls, columns, etc. Pre-Cut DCI™ Mat to fit using a utility knife. Dry fit into area to ensure cuts are precise. Any special cuts like "L" cuts around a counter or hole cuts for plumbing should also be done at this point.



5 Prepare mortar that is approved for subfloor. Use maximum allowed water per mortar manufacturer's specification.



BEST PRACTICE: Prepare pre cut mat by gathering into rolls for easy application.



6 Trowel required to adhere mat: **4.5mm X 4.5mm** square notch, or **3/16" X 3/16"** square notch **Coverage may vary with mortar consistency, angle at which the trowel is held, substrate flatness, etc.**



7 Spread mortar ahead of mat. Apply a skim coat of mortar with flat side of trowel, then go over with notch side to ensure good bond to subfloor. **Mat must embed into WET mortar.** Do not spread too far as mortar may dry or "skin over"

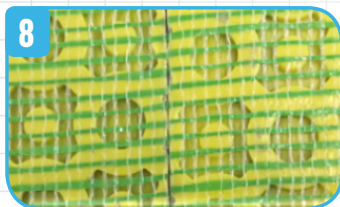

8 Triton DCI™ Mat is installed with the **YELLOW** side facing upwards. Adjoining sheets of DCI Mat should be installed without leaving space between sheets.



9 Apply pressure to mat using a wooden or magnesium float to embed the mat into the mortar. Mat will appear to darken as it becomes well embedded into the mortar. 100% coverage is required.



BEST PRACTICE: Use roller to embed mat. This provides more pressure and ensures a superior bond to the anchoring fleece on the backside of DCI™ Mat.



10 Periodically check for 100% coverage of mortar under the mat. If poor coverage exists, or mortar appears to have "skinned over," remove mat, clean area and repeat steps 7-9 as needed.



11 For a Watertight application use Triton WP™ Tape embedded into mortar at each of the seams. Ensure tape is centered on seam to achieve a minimum 2" (50mm) overlap with the DCI™ mat on each side of the seam.



12 Ready to Tile immediately. Use trowel and mortar specified by tile manufacturer.

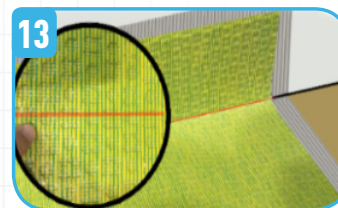

13 Triton DCI™ Mat features a convenient crease that runs the length of the roll. This provides for a watertight installation on balconies where the subfloor meets the exterior wall.

Must be installed in compliance with appropriate ANSI and industry standards and TCNA recommendations for interior and exterior applications.

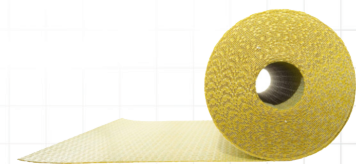

WPBK INSTALLATION GUIDE



1 ENSURE FRAMING IS STRUCTURALLY SOUND AND PROPERLY ALIGNED

- Must comply with ANSI A108.11 and local building code
- Use a minimum of 2"x4" wood studs or 20 gauge metal studs at maximum **16" o.c.**

2 DETERMINE LAYOUT

- WPBK™ edges parallel to framing must be structurally supported
- Cut WPBK™ to size, make needed cutouts and holes
- Allow 1/8" gap between backer sheets and 1/4" gap between WPBK™ and floor, tub or shower pan (to be caulked accordingly)

3 ATTACH WPBK™ TO FRAMING MEMBERS

- Use proper nails or screws at maximum **8" o.c.**
- Keep **3/8"** from WPBK™ edge & 2" from corners
- Set fasteners flush with WPBK™
- Approximately **25-30** fasteners are required per sheet

4 TREAT FASTENER PENETRATIONS

- 4a** Adhere Triton WP™ Tape with mortar centered over penetrations ensuring a minimum of 2" radius from penetration.
- 4b** Alternate method: Cover each penetration with Triton AD™ adhesive sealant

5 TREAT SEAMS & PLUMBING PENETRATIONS

- Apply mortar to seams and embed Triton WP™ Tape
- Use Triton WP™ inside and outside corners where applicable
- Use Triton WP™ collars at shower head and mixing valve



PROPER FASTENERS: CORROSION RESISTANT
Roofing Nails or Cement Backer Screws
Min. 1 1/4" for interior Walls.
Min. 1 3/4" for Exterior Walls

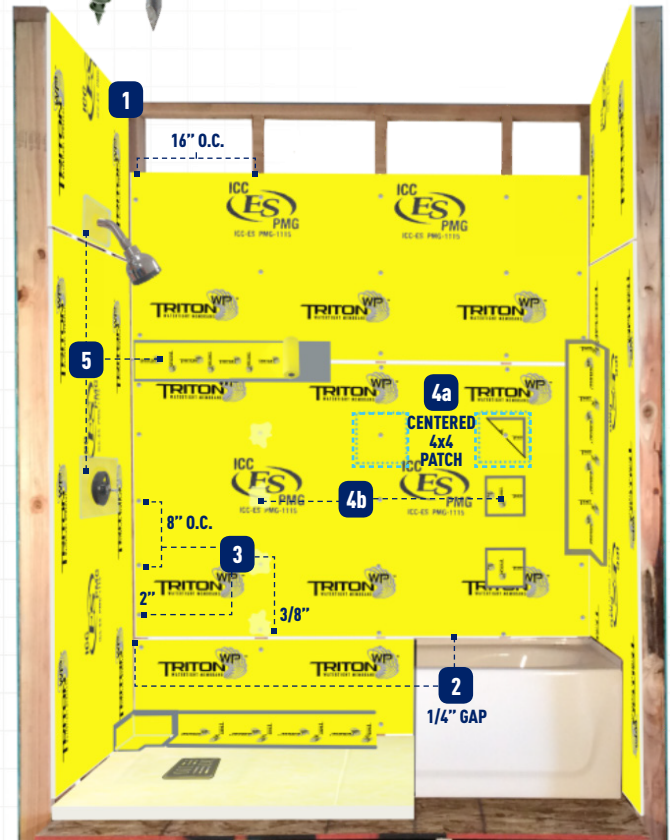

CUT TRITON WPBK™ WITH A UTILITY KNIFE - SCORE AND SNAP AWAY

