

REVISION	NOTES	CHANGED BY	CHECKED BY	RELEASE DATE
01	RELEASE TO PRODUCTION	TC	JC	5/4/18
02	MATERIAL WAS 316L	BAYER		6/19/18
03	THICKNESS WAS .040. ADDED BRUSH DIRECTION	BAYER		7/20/18

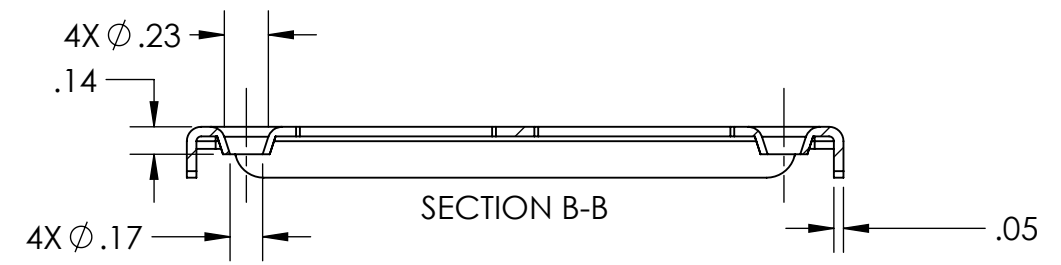
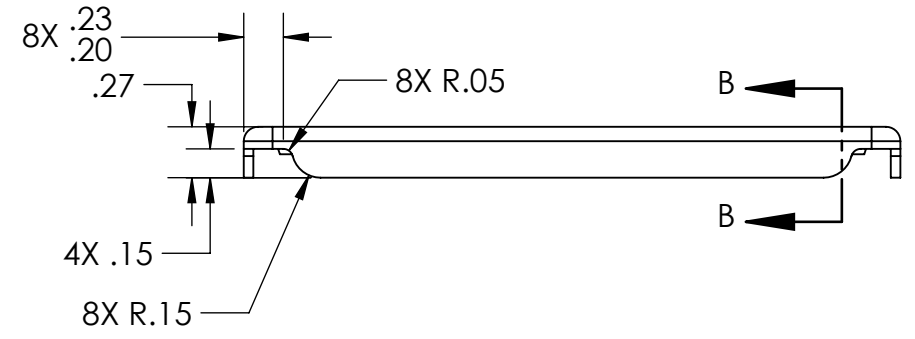
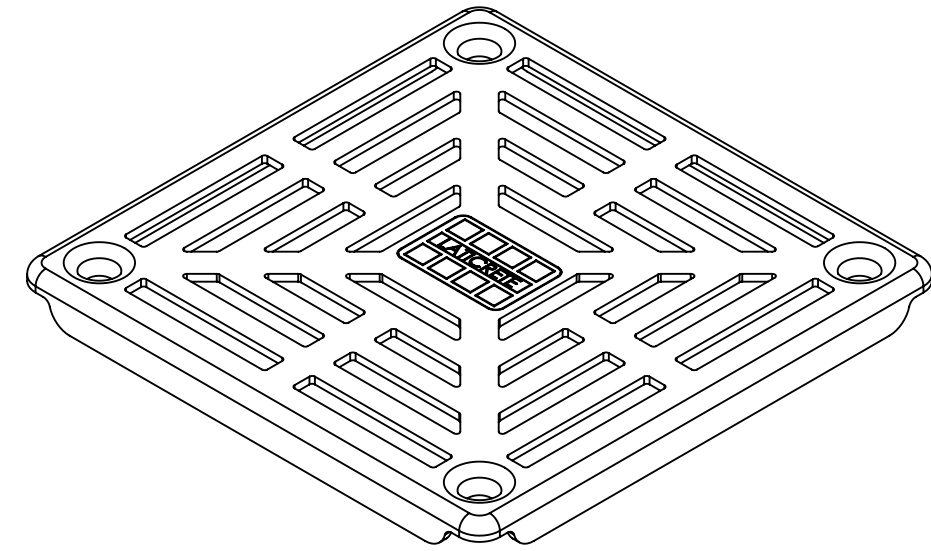
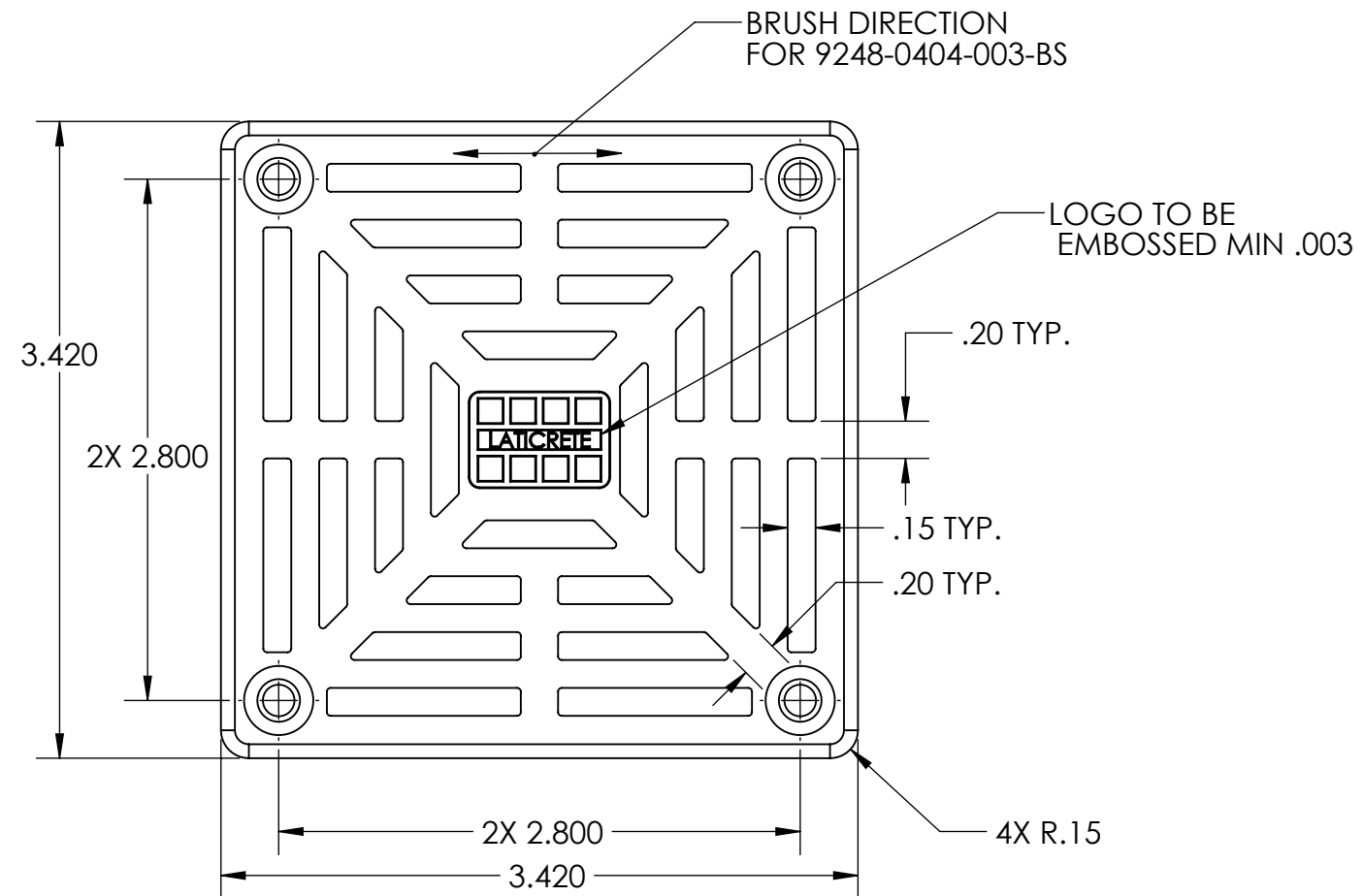

- NOTES:
1. MATERIAL CERTIFICATION AND C OF C REQUIRED ON ALL LOT RUNS.
 2. PART TO BE FREE OF BURRS AND SHARP EDGES .010 MAX.
 3. DRAWING IS FOR INSPECTION PURPOSE ONLY. ALL UNDIMENSIONED FEATURES TO BE HELD $\pm .010$ WITH RESPECT TO 3D CAD MODEL.

PART NUMBER	DESCRIPTION	FINISH
9248-0404-003-BS	4" X 4" STAMPED GRATE	BRUSHED STAINLESS STEEL
9248-0404-003-PS	4" X 4" STAMPED GRATE	POLISHED STAINLESS STEEL
9248-0404-003-MB	4" X 4" STAMPED GRATE	MATTE BLACK
9248-0404-003-ORB	4" X 4" STAMPED GRATE	OIL RUBBED BRONZE

PROPRIETARY AND CONFIDENTIAL

THE INFORMATION CONTAINED IN THIS DRAWING IS THE SOLE PROPERTY OF LATICRETE INTERNATIONAL INC. ANY REPRODUCTION IN PART OR AS A WHOLE WITHOUT THE WRITTEN PERMISSION OF LATICRETE INTERNATIONAL INC. IS PROHIBITED.

LATICRETE INTERNATIONAL INC.
91 AMITY ROAD
BETHANY CT 06524

UNLESS OTHERWISE SPECIFIED:	NAME	DATE
DIMENSIONS ARE IN INCHES	DRAWN	TC
TOLERANCES:	CHECKED	PB
ANGULAR: MACH ± 2 BEND ± 5	ENG APPR.	JC
TWO PLACE DECIMAL $\pm .010$	MFG APPR.	
THREE PLACE DECIMAL $\pm .005$	Q.A.	
INTERPRET GEOMETRIC TOLERANCING PER: ASME Y14.5 - 2009	COMMENTS:	
MATERIAL		
SST 304L		
FINISH		
SEE TABLE		
DO NOT SCALE DRAWING		

LATICRETE		
TITLE:		
STAMPED METAL GRATE		
SIZE	DWG. NO.	REV
B	9248-0404-003	03
SCALE: 1:1	WEIGHT:	SHEET 1 OF 1